

VIDEO SELECTOR

Winnebago Industries has recently started offering the Winegard Entertainment Selector System in certain vehicles. Over the years we have used several different video selectors to keep pace with our entertainment system offerings. The most noticeable improvement in the Winegard selector over previous models we have used is that it incorporates a built-in antenna amplifier switch. The following is from the Winegard Entertainment Select owner's manual.

Features

- Simple push button controls allow you to send signals from any one of five different inputs to two TVs and VCR.
- Five inputs are Satellite Receiver, TV Antenna, VCR, Cable TV and Auxiliary.
- Three Outputs: Main TV, TV 2, VCR.
- Built-in +12 VDC TV antenna power supply eliminates need for separate wall mounted TV antenna power supply.
- Self-resetting fuses used in antenna power supply prevent failure caused by shorted connections.
- Video switch allows for independent viewing of signals at different TVs, with a record option from VCR.
- Low profile housing blends nicely with other electronic components; fits easily in overhead cabinets.
- Shielded circuitry for high isolation and low signal loss.
- Oversize, easy to read graphics for proper function selection when mounted in out of the way locations.

Winegard Entertainment Select All VS Models

Model shown has five inputs, three outputs.

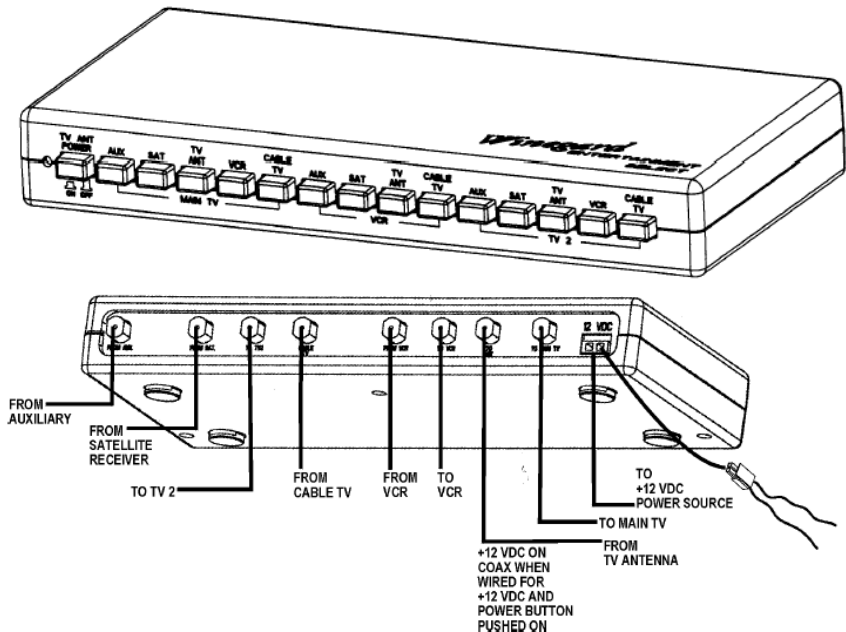

Coax Cable Connections

Step 1 Connect the coax cable from the output on the switch box marked "To Main TV" to the antenna input connection on the back of the main TV.

Step 2 Connect the coax cable from the output on the switch box marked "To TV 2" to the antenna input connection on the back of the second TV.

Step 3 Connect the coax cable from the output on the switch box marked "To VCR" to the input connection on the back of the VCR.

Step 4 Connect the coax cable from the output of the VCR to the coax connection on the back of the switch box marked "From VCR."

Step 5 Connect the coax cable from the exterior Cable TV input plate to the coax connection on the switch box marked "From Cable TV."

Step 6 The output of the auxiliary device (TV game, camcorder, etc.) can be connected to the input connection marked "From Aux."

Step 7 Connect the coax cable from the output of the satellite receiver marked "To TV" to the input connection on the back of the switch box marked "From Sat."

NOTE: The coax cable from the satellite antenna must go directly to the input of the satellite receiver marked "Satellite In'."

Step 8 Connect the coax cable from the TV antenna to the coax connection on the back of the switch box marked "From TV Ant."

Power Connections

NOTE: When hooking up an amplified antenna see Figure C. If you are unsure whether your antenna is amplified or non-

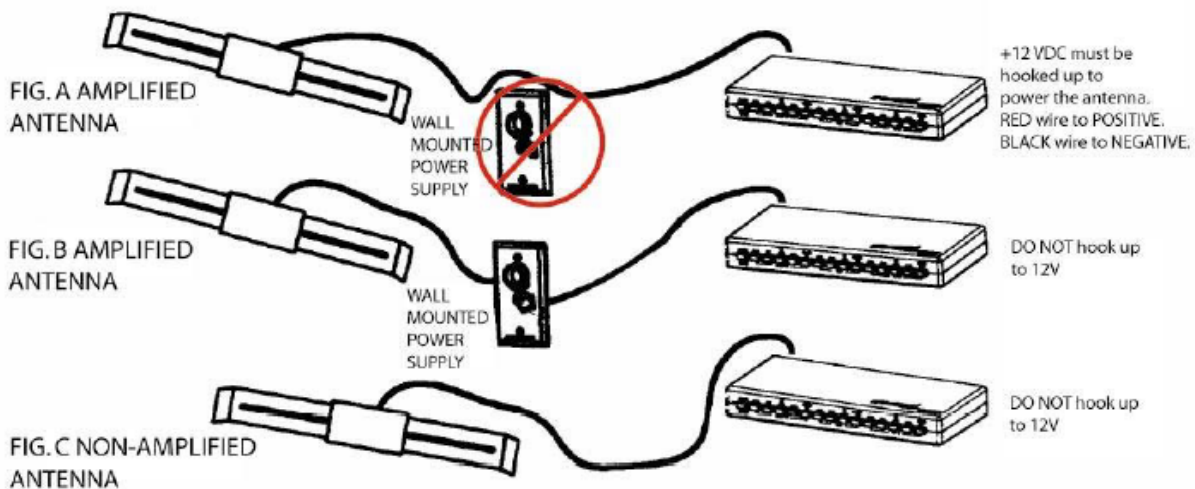

amplified, contact the manufacturer of the antenna or your dealer. If using VS-0503 as shown in Fig A, use the wires and connector supplied and connect per +12 VDC Note to the right of Fig. A.

Figure A. (Bypassing the Wall Mounted Power Supply)

When using Winegard or another brand of VHF/UHF "Amplified Antenna," you must hook up the +12 VDC power to the back of the control box. The Power Indicator LED will only light when the Power button is on.

Figure B. (Using the Antenna's Wall Mounted Power Supply)

When using Winegard or another brand of VHF/UHF "Amplified Antenna" with power supply, you don't need to hook up the +12 VDC to the control box if you are using the antenna's separate wall mounted power supply. The TV Antenna Power Button is only used when wired for an amplified antenna. The Power Indicator LED will only light when the switch box is wired per Fig. A.

Figure C. When using Winegard or another brand "Non-Amplified Antenna," the +12 VDC should NOT be used. The TV Antenna Power Button is only used when wired for an amplified antenna. The Power Indicator LED will only light when the switch box is wired per Fig. A.

Operation

Once all the connections have been properly made to the control box, you are ready to watch your favorite programming.

Using the buttons on the front of the control box

Viewing

Step 1 To view signals from an amplified TV Antenna, first press the TV Antenna Power button to the ON position. This provides +12 volt power to the TV antenna amplifier located inside the antenna housing. To view the TV antenna signal on the main TV, simply press the TV ANT button located above the area marked "MAIN TV." Follow the same procedure for TV 2.

NOTE: The picture quality from your outdoor TV antenna varies depending on the location of the TV station in relationship to your location. If picture quality is degraded and you are not using an external power supply, try turning the TV Antenna Power button on your control box Off and On. If your TV antenna is powered by an external wall mounted power supply, try turning it Off and On.

Step 2 To view Satellite signals on your main TV, press the SAT button above the area marked "Main TV." Follow the same procedure for TV 2.

Step 3 To view Cable TV signals on your main TV, press the Cable TV button above the

area marked "Main TV." Follow the same procedure for TV 2.

NOTE: To view Cable TV signals, you must be connected to a Cable TV input on the outside of your vehicle. Cable TV inputs are available at many of today's campgrounds.

Step 4 To view VCR signals on your main TV, press the VCR button above the area marked "Main TV." Follow the same procedure for TV 2.

Step 5 To view Auxiliary signals, such as games, camcorder, etc., on your main TV, press the Aux button above the area marked "Main TV." Follow the same procedure for TV 2.

Recording

Step 6 To record programming from the Antenna, Satellite Antenna, Cable TV or Auxiliary, simply press the appropriate button above the section marked VCR.

To record programming from the TV antenna to your VCR, press the TV ANT button above the VCR section of the switch box.

To record programming from the Satellite antenna to your VCR, press the SAT button above the VCR section on the switch box.

To record programming from an Auxiliary device to your VCR, press the AUX button above the VCR section.

To record programming from Cable TV to your VCR, press

the Cable TV button above the VCR section on the switch box.

NOTE: To record Cable TV signals, you must be connected to a Cable TV input on the outside of your vehicle. Cable TV inputs are available at many campgrounds.

NOTE: With Winegard's control box, you can watch different programming on each of your two TV sets while recording another program on your VCR. If your vehicle is equipped with an exterior patio TV set, you may choose the programming source desired for the patio TV by using the buttons above the TV 2 section on the control box. The programming source is the same for the patio (exterior) TV and TV 2. When viewing signals on the patio TV, you cannot view different signals on TV 2. You could watch different signals on the main TV.

Troubleshooting

If the unit doesn't switch properly between inputs, (TVs, VCR, SAT, CABLE, etc.) be sure the coax is connected to the proper jacks on the back of the control box. Make sure the center conductors of the coax cables are not bent and are making good contact. See "Installing Coax Connectors" (at right).

If you are using the +12 VDC and light does not turn ON when pushing the power button, go through the following steps.

1. Be sure the unit is wired into a +12 VDC source and that this source is supplying power to the plug going to the control box. Check to make sure all connections are correct.

2. If power is being supplied to the control box and the light still does not go on when

pushing the TV Antenna Power Button, disconnect the coax from the jack labeled "From Antenna" on the back of the control box. If the light now comes on, there is a short in your coax cable going to the outside antenna, or the amplifier in your antenna is bad.

3. Reattach the coax cable to back of the control box. Disconnect it at the TV antenna. If the light comes on, the coax cable is connected properly and the problem is in the antenna. If the light does not come on, the problem is in the coax cable.

NOTE: The picture quality from your outdoor TV antenna varies depending on the location of the RV station in relationship to your location. If picture quality is degraded and you are not using an external power supply, try turning the TV Antenna Power button on your control box Off and On. If your TV antenna is powered by an external wall mounted power supply, try turning it Off and On.

Installing Coax Connectors

1. Strip outer cover back 1/2" from end of cable. Fray braid back as far as outer cover will allow.

2. Trim braid close to outer cover and remove 1/4" of inner insulation. Be careful not to nick center conductor and make sure no foil or braid can touch center conductor.

3. Slide connector tip between braid and inner insulation (braid and foil, on foil shield cable), and push connector on cable as far as it will go. Crimp built-in ferrule with appropriate crimping tool. Do not crush cable out-of-round. (If you are installing in very hot weather, increase these dimensions 1/8").

