



**DANGER**

**Danger of electrical shock, burns or death.** Always remove all power sources before attempting any repair, service or diagnostic work. Power can be present from shore power, generator, inverter or battery. All power sources must be disabled and secured before performing any service.



**CAUTION**

If you lack the skills, tools or equipment to perform diagnostic or repair work leave such work to an authorized Winnebago Industries dealer or other qualified shop.

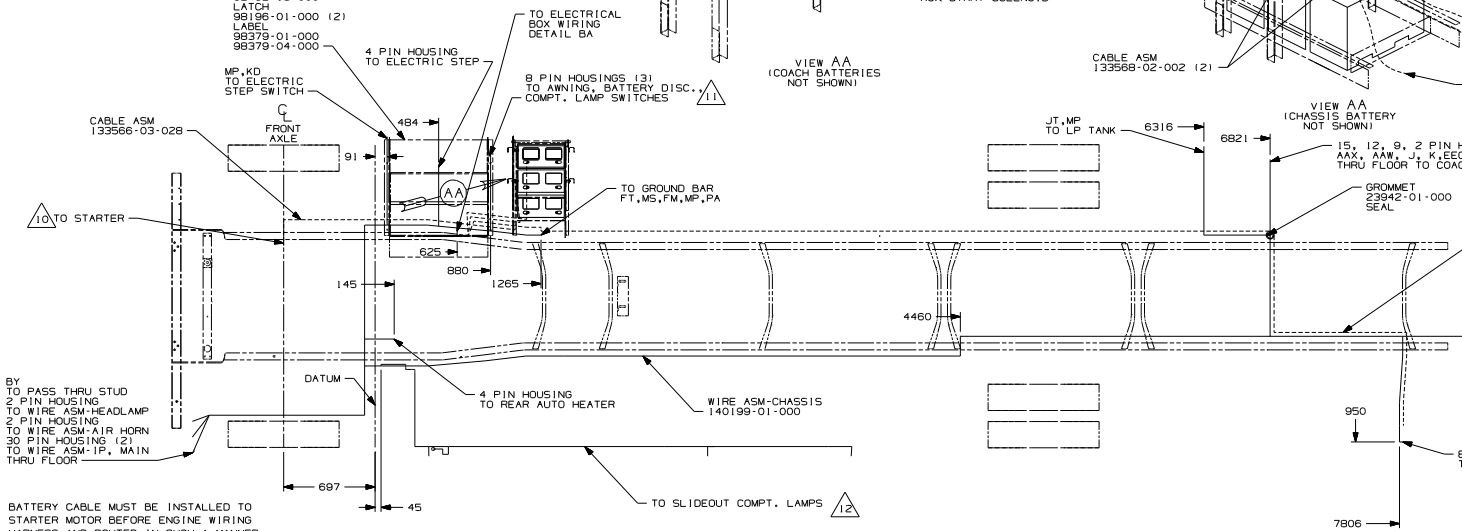
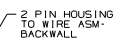
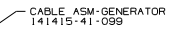
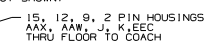
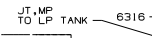
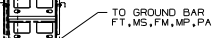
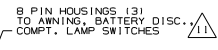
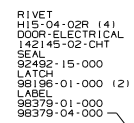
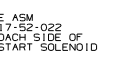
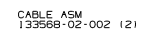
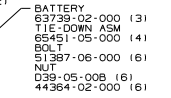
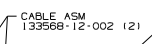
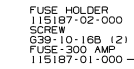
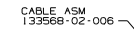
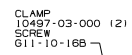
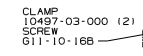
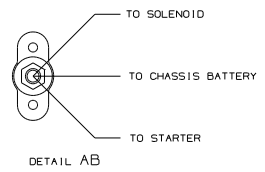

BY TO PASS THRU STUD TO 2 PIN HOUSING TO WIRE ASM-HEADLAMP 2 PIN HOUSING TO WIRE ASM-AIR HORN 30 PIN HOUSINGS (2) TO WIRE ASM-1P, MAIN THRU FLOOR

- 10 BATTERY CABLE MUST BE INSTALLED TO STARTER MOTOR BEFORE ENGINE WIRING HARNESS AND ROUTED IN SUCH A MANNER AS TO PREVENT ANY POSSIBLE DEGRADATION FROM THE EXHAUST SYSTEM.
- 9 USE TWO NUTS HERE TO ACCOUNT FOR BATTERY HEIGHT DIFFERENCE.
- 8 SEE WIRING INSTL-FRONT END FOR ADDITIONAL INFORMATION.
- 7 CLAMP 10497-02-000 AND SCREW 639-08-000.
- 6 CLAMP B3609-01-000 AND SCREW 639-08-000.
- 5 CLAMP B3610-01-000 AND SCREW 639-08-000.
- 4 WIRE TIE B343-04-000. FASTEN EVERY 600 MM MINIMUM.
- 3 ALL DIMENSIONS ARE FROM DATUM UNLESS OTHERWISE SPECIFIED.
- 2 SECURE CONDUIT 41953-01-000, -02, ANBD -03 OVER ALL WIRES THAT CONTACT SHARP EDGES.
- 1 LEGEND: — WINNEBAGO, - - - - - CABLE, - - - - - CHASSIS SUPPLIED.
- 12 COIL UP EXTRA WIRE AND TIE BACK TO LOOM.
- 11 SEE WIRING INSTL-BODY FOR ADDITIONAL INFORMATION.

FOR ELECTRICAL TORQUE SPECIFICATIONS SEE DWG NO. 128793-01-000

FOR ELECTRICAL CALLOUTS SEE DWG NO. 121339-01-000

1B1 265 1PR

# WINNEBAGO

DATE: 09/20/01  
 DWR: ALL DIMENSIONS ARE IN MILLIMETERS  
 P.E.:  
 W.E.:  
 DWR: 02 L36W

UNSPECIFIED TOLERANCES ARE:  
 HOLE DIA: .015  
 ONE-PLACE: .015  
 TWO-PLACE: .015  
 HOLE: .015

THIRD ANGLE PROJECTION

DO NOT SCALE DRAWING

TITLE: WIRING INSTL-CHASSIS  
 SHEET 1 of 2 PART NO. 140751

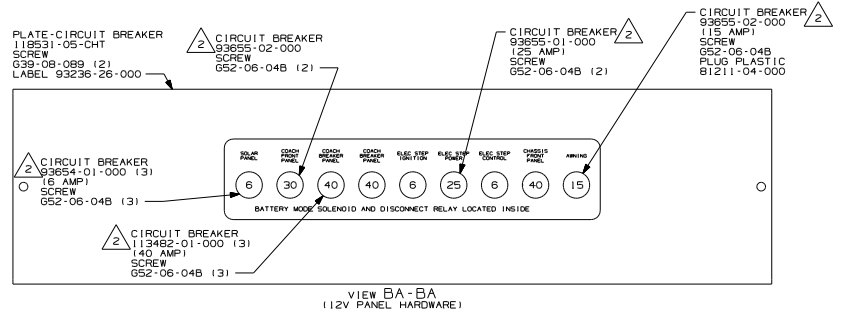
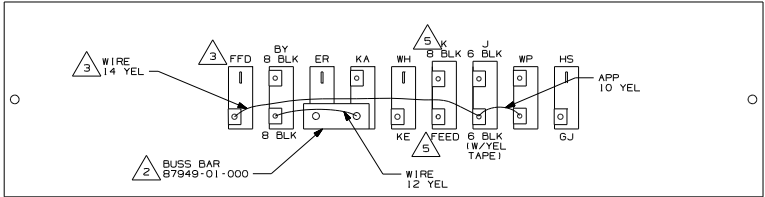
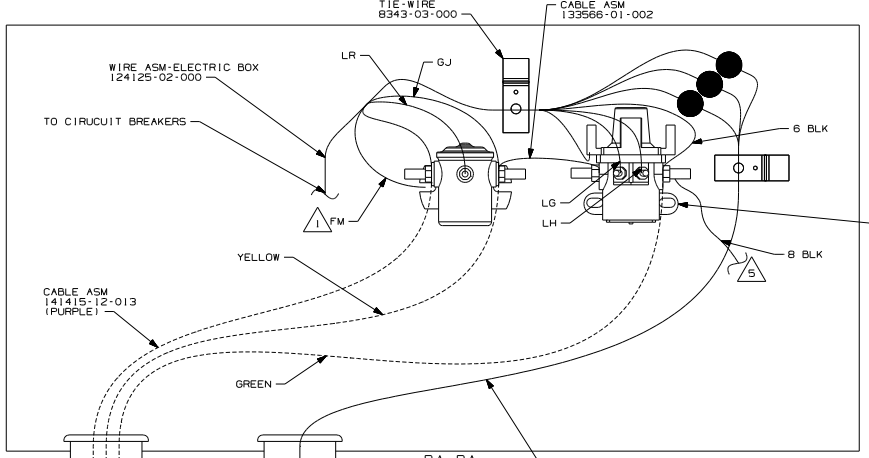

- 5 FROM WIRE ASM-CHASSIS.
- 4 WITHOUT (52N).
- 3 TIE BACK TO LOOM WITHOUT (52N).
- 2 ADD LOCK WASHER OME028-04-071 PER SCREW.
- 1 SECURE WITH SOLENOID MOUNTING SCREW.

- (52N) AWNING-PAT10-ELECTRIC
- (265) CODES/STANDARDS-CSA/CMVSS
- (1B1) CODES/STANDARDS USA
- (1B1) (265) (52N)

FOR ELECTRICAL TORQUE SPECIFICATIONS SEE DWG NO. 128793-01-000

FOR ELECTRICAL CALLOUTS SEE DWG NO. 121339-01-000

FIRST USED	02 L36W
DO NOT SCALE DRAWING	
TITLE:	WIRING INSTL-CHASSIS
SHEET 2	PART NO 140751